

Courses and distance
down the River

S 76 E 32
S 81 E 36
S 60 E 48
S 66 E 60
S 91 E 8
Total 184

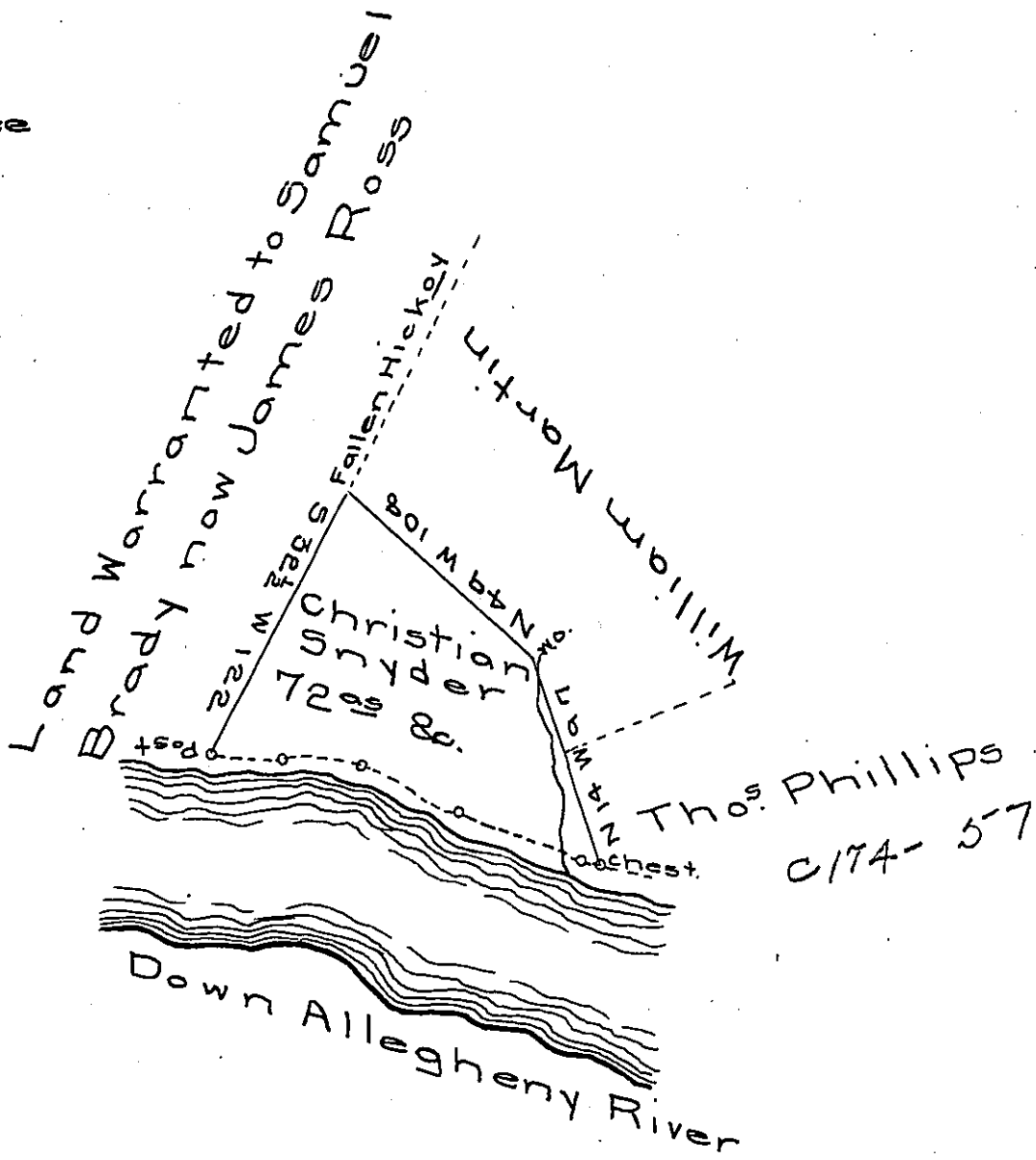

In pursuance of a warrant dated January 7th 1839 granted to Christian Snyder. Surveyed to the same on the 8th day of Feb^y 1839 the above described tract of land containing seventy two acres and allowance of six per cent &c. Situate in Madison township Armstrong County.

Jonathan E. Meredith D.S.

To John Taylor Esq^r }
 Surveyor General }

IN TESTIMONY that the above is a copy of the original remaining on file in the Department of Internal Affairs of Pennsylvania, made conformably to an Act of Assembly approved the 16th day of February, 1833, I have hereunto set my Hand and caused the Seal of said Department to be affixed at Harrisburg, this fourth day of February 1907.

George R. Brown
 Secretary of Internal Affairs.